

DTP08-250kg-R500-CA10

SWL - 250kg

CLEAN MILD STEEL CONSTRUCTION WITH POWDERCOATED FINISH IN RAL 5010 (BLUE)

ADJUSTABLE CYLINDER SECURING USING A RATCHET AND STRAP ARRANGEMENT FOR CYLINDER WITH DIAMETER OF 140MM TO 450MM

RACK OFFERS VERTICAL HEIGHT ADJUSTMENT FOR DIFFERENT DRUM SIZES

500MM STROKE HYDRAULIC RAM FITTED WITH BURST VALVE

MANUAL HYDRAULIC LIFT HAND PUMP AND TANK WITH THROTTLING LOWERING VALVE

CLEAR POLYCARBONATE GUARDING

TILLER HANDLE WITH SPRING RETURN

BRAKED SINGLE WHEEL REAR STEERING

160MM POLYURETHANE WHEELS

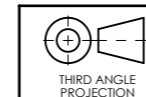

ALL DIMENSIONS IN mm U.O.S
DO NOT SCALE



DESCRIPTION:
DTP08-250KG-R500-CA10, DEPALLETISER, 500MM STROKE, 250KG SWL

CUSTOMER APPROVAL:
NAME:
SIGNATURE:
DATE:

THIS DOCUMENT AND ALL THE INFORMATION CONTAINED HEREIN ARE CONFIDENTIAL AND EXCLUSIVE PROPERTY OF STS BESPOKE HANDLING EQUIPMENT AND MAY NOT BE REPRODUCED, USED, DISCLOSED OR MADE PUBLIC IN ANY MANNER PRIOR TO EXPRESS WRITTEN AUTHORIZATION BY STS BESPOKE HANDLING EQUIPMENT.
THIS DOCUMENT IS ACCEPTED PURSUANT TO AGREEMENT TO THE FOREGOING, AND MUST BE RETURNED OR DESTROYED UPON DEMAND.
MANUFACTURER AGREES THAT ARTICLES MADE IN ACCORDANCE WITH THIS DOCUMENT SHALL BE CONSIDERED STS BESPOKE HANDLING EQUIPMENT'S DESIGN AND THAT IDENTICAL ARTICLES OR PARTS THEREOF SHALL NOT BE MANUFACTURED FOR THE USE OR SALE BY THE MANUFACTURER OR ANY OTHER PERSON OR ENTITY WITHOUT PRIOR EXPRESS WRITTEN AUTHORIZATION BY STS BESPOKE HANDLING EQUIPMENT.

SHEET NO: 1 OF 3
DRAWN BY: IH
SHEET SIZE: A3
PART NUMBER: 021671

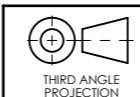
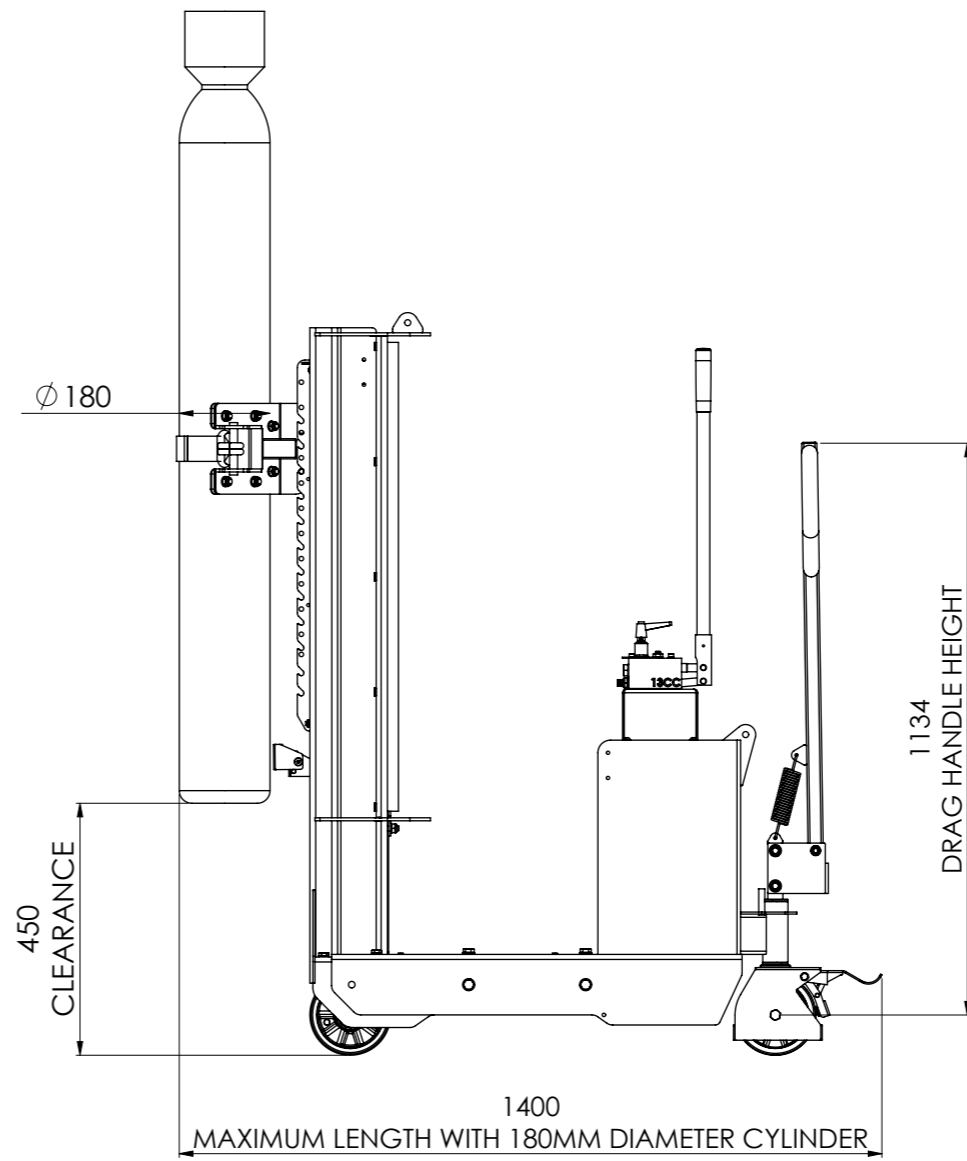
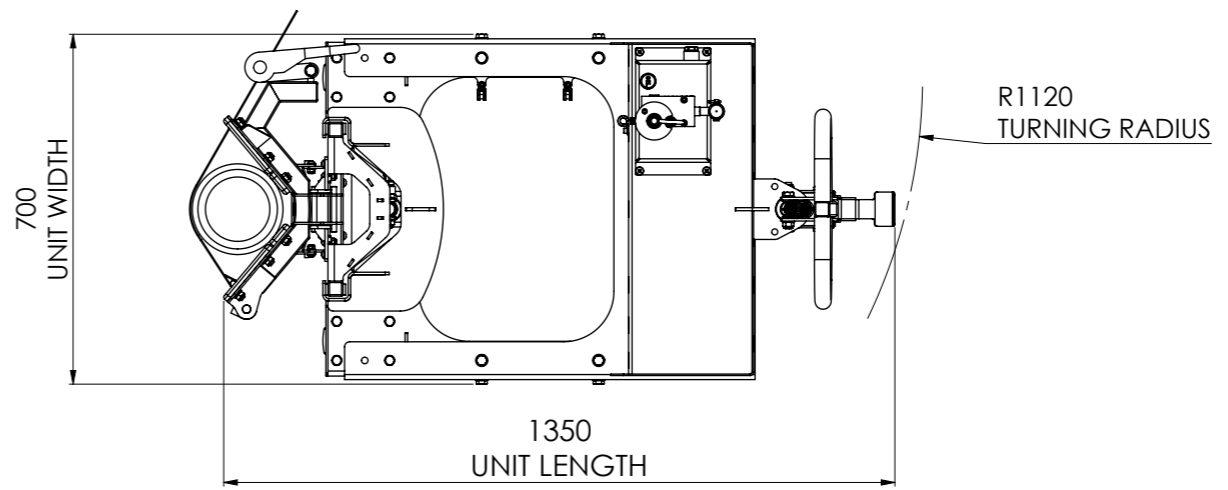
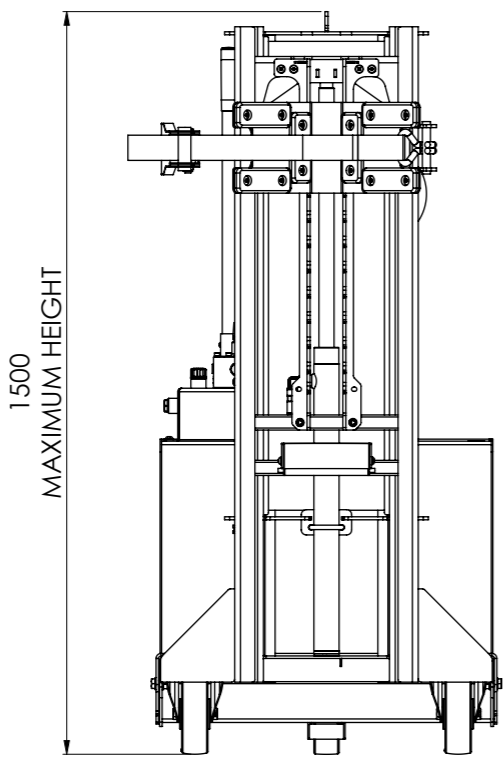

ALL DIMENSIONS
IN mm U.O.S
DO NOT SCALE

DESCRIPTION:
DTP08-250KG-R500-CA10, DEPALLETISER, 500MM STROKE, 250KG SWL

SHEET NO: 2 OF 3

DRAWN BY: IH

SHEET SIZE: A3



CUSTOMER APPROVAL:
NAME:
SIGNATURE:
DATE:

THIS DOCUMENT AND ALL THE INFORMATION CONTAINED HEREIN ARE CONFIDENTIAL AND EXCLUSIVE PROPERTY OF STS BESPOKE HANDLING EQUIPMENT AND MAY NOT BE REPRODUCED, USED, DISCLOSED OR MADE PUBLIC IN ANY MANNER PRIOR TO EXPRESS WRITTEN AUTHORIZATION BY STS BESPOKE HANDLING EQUIPMENT.
THIS DOCUMENT IS ACCEPTED PURSUANT TO AGREEMENT TO THE FOREGOING, AND MUST BE RETURNED OR DESTROYED UPON DEMAND.
MANUFACTURER AGREES THAT ARTICLES MADE IN ACCORDANCE WITH THIS DOCUMENT SHALL BE CONSIDERED STS BESPOKE HANDLING EQUIPMENT'S DESIGN AND THAT IDENTICAL ARTICLES OR PARTS THEREOF SHALL NOT BE MANUFACTURED FOR THE USE OR SALE BY THE MANUFACTURER OR ANY OTHER PERSON OR ENTITY WITHOUT PRIOR EXPRESS WRITTEN AUTHORIZATION BY STS BESPOKE HANDLING EQUIPMENT.

PART NUMBER:
021671